

This document can be made available in other accessible formats as soon as practicable and upon request

STAFF REPORT: ENGINEERING AND PUBLIC WORKS DEPARTMENT



REPORT TO: Committee of the Whole
MEETING DATE: August 18, 2014
REPORT NO.: EPW.14.064
SUBJECT: Historic Snowbridge Entrance
Works – 2014 Update
PREPARED BY: Brian Kane, Roads Foreman

A. Recommendations

THAT Council receive Staff Report EPW.14.064, “Historic Snowbridge Entrance Works – 2014 Update”;

AND THAT Council approve monitoring maintenance operations regarding the remaining portions of the islands located in the entrance portion of Snowbridge Way during the winter of 2014/2015 for further report back to Council in 2015.

B. Background

The purpose of this report is to describe the experience the Roads and Drainage Division has had with the entrance islands to the Historic Snowbridge Development and consideration of completed and proposed modifications to the entrance islands in an effort to improve winter maintenance operations and to lessen operational costs.

At the August 20, 2013 Infrastructure & Recreation Committee Meeting, the following Recommendation was passed and approved at the Council meeting of August 26, 2013:

THAT Council receive Staff Report EPW.13.063, “Historic Snowbridge Entrance Works”;

AND THAT Council direct Staff to remove up to 5.0 meters(15 feet) as necessary of the first island at Grey Road 19 and remove the final island at the intersection with the internal portion of Snowbridge Way as described as Stage One in Report EPW.13.063;

AND THAT Staff review the matter in 2014 and present the matter to Council if necessary, Carried.

This Report represents the 2014 review of the matter.

With reference to Figure 1 below, the Stage One remedial works completed in 2013 were:

Remove the first 5.0 metres (15 feet) of the first island (Island #1) at Grey Road 19 and remove the final island (Island #4) at the intersection with the internal portion of Snowbridge Way. These works resulted in the removal of only one (1) tree. The tree located in the final island and was removed with the rest of the island structure. The tree located at the CR 19 entrance was left in place and will be monitored.

It was noted in 2013 that staging of the works would permit work to be completed over two years depending on available resources and direction of Council. As proposed in 2013, Stage Two of the works noted in Staff Report EPW.13.063 are to be as follows:

Remove the eastern half of the second island in from Grey Road 19 (Island #2). The proposed modifications consist of the removal of approximately 30m of island and 4 trees.

Figure 1: Snowbridge Entrance Islands

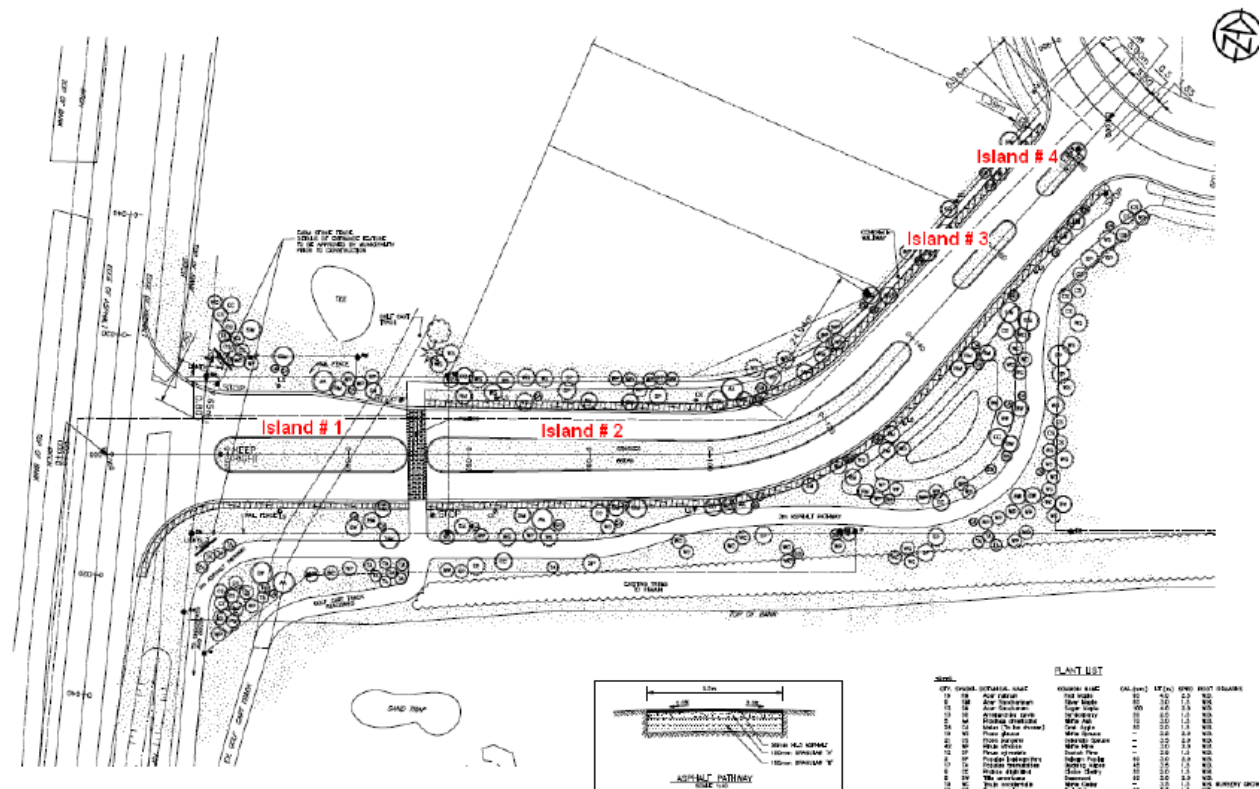

During the winter of 2013/2014, access from Grey Road 19 to the entrance portion of Snowbridge Way has been noted by Operators as much better. In addition, access from the entrance portion to the internal portion of Snowbridge Way is much improved.

One operational change developed by Staff was to use a tractor and snowblower to remove snow along the Snowbridge Way entrance and at the internal intersection of Snowbridge Way. The blower was able to remove the snowbanks between the back of the curb and the streetlights. This allowed trucks and equipment to ride over the rollover curb along the right hand side of the road and not drive over the barrier curb on the left hand side of the road. This improved access to the subdivision. The Town tractor and blower were initially used but given travel time proved cost-prohibitive. When required, a local contractor was retained to perform the snow blowing which has reduced costs versus the use of Town equipment.

Although it is the objective of the Town to have road designs that do not require special or unique operational requirements due to increased operational costs at this time, it is recommended that Staff continue to monitor maintenance operations regarding the remaining islands located in the entrance portion of Snowbridge Way during the winter of 2014/2015 for further report back to Council in 2015.

C. The Blue Mountains' Strategic Plan

Goal No. 2, "Addressing the Town's municipal infrastructure needs".

D. Environmental Impacts

None at this time.

E. Financial Impact

During the winter of 2013/2014, this cost was approximately \$1700 to hire a local contractor to remove the snowbanks adjacent to the travelled portion road. These costs do not include staff time to monitor, supervise and administer the works

F. In Consultation With

Jim McCannell, Manager of Roads and Drainage.

G. Attached

None.

Respectfully submitted,

Brian Kane

Brian Kane
Roads Foreman

Engineering & Public Works

Office: 519-599-6714

Fax: 519-599-7723

bkane@thebluemountains.ca

Reg Russwurm

Reg Russwurm
Director, Engineering and Public
Works