

STAFF REPORT: Recreation Department



**REPORT TO: Infrastructure and Recreation
Committee**

MEETING DATE: April 28, 2009

REPORT NO.: DOR.09.22

SUBJECT: Youth Community Garden

**PREPARED BY: Joanna Garland
Youth Advisor
Shawn Everitt
Director of Recreation**

A. Recommendations

THAT Council receives Staff Report DOR.09.22 "Youth Community Garden" for information purposes.

B. Background

After meeting with the Youth Council on April 7th, 2009 a plan to create an organic community vegetable garden has emerged. An appropriate location would be at Tomahawk Recreation Complex close to a well for convenient watering and in close proximity to where the nursery will be. This particular location currently has no plan for development and is accessible to our community.

The garden will be designed and maintained solely by the Blue Mountains Youth Council and any community member who would like to help. Creating mentorships between experienced gardeners and Youth would help create intergenerational partnerships and activity within our community.

A schedule would be designed for volunteers to follow. There would be approximately 7-10 people responsible for the garden at different times. The size of the garden would be modest to begin with; a measurement of 8mx4m.

A variety of produce from lettuce and herbs to tomatoes and peas would be grown. The plan for harvested crops would be to sell them at local markets and to members of the community. The proceeds would go towards local Youth Council initiatives and back into the garden. If there were specific Youth related events that required snacks it would be ideal to use the vegetables grown from the garden.

This garden would be a means of bringing our community together and would also allow our local youth population to really connect with our environment and be proud of something they developed on their own with support of the Town.

C. The Blue Mountains' Strategic Plan

Supporting the development of social and recreational programs to meet the broad range of needs in the community.

Managing growth to ensure the ongoing health and prosperity of the community.

D. Environmental Impacts

Promoting sustainability in our community as well as organic gardening and eating locally.

Connecting with the land in our community which leads to respect for our environment.

E. Budget Impact

Organic seeds/seedlings \$150
Tools \$400
Soil/fertilizer \$200
Shed/Storage structure \$1000

Total- \$1750.00

F. Attached

A. Site Plan – Tomahawk Soccer Park

Respectfully submitted,
Joanna Garland, Youth Advisor

Shawn Everitt, Director of Recreation

Signature

Signature

For more information, please contact:

Name: Joanna Garland

Email Address: jgarland@thebluemountains.ca

Business Telephone with Extension 519-599-3131 X 303

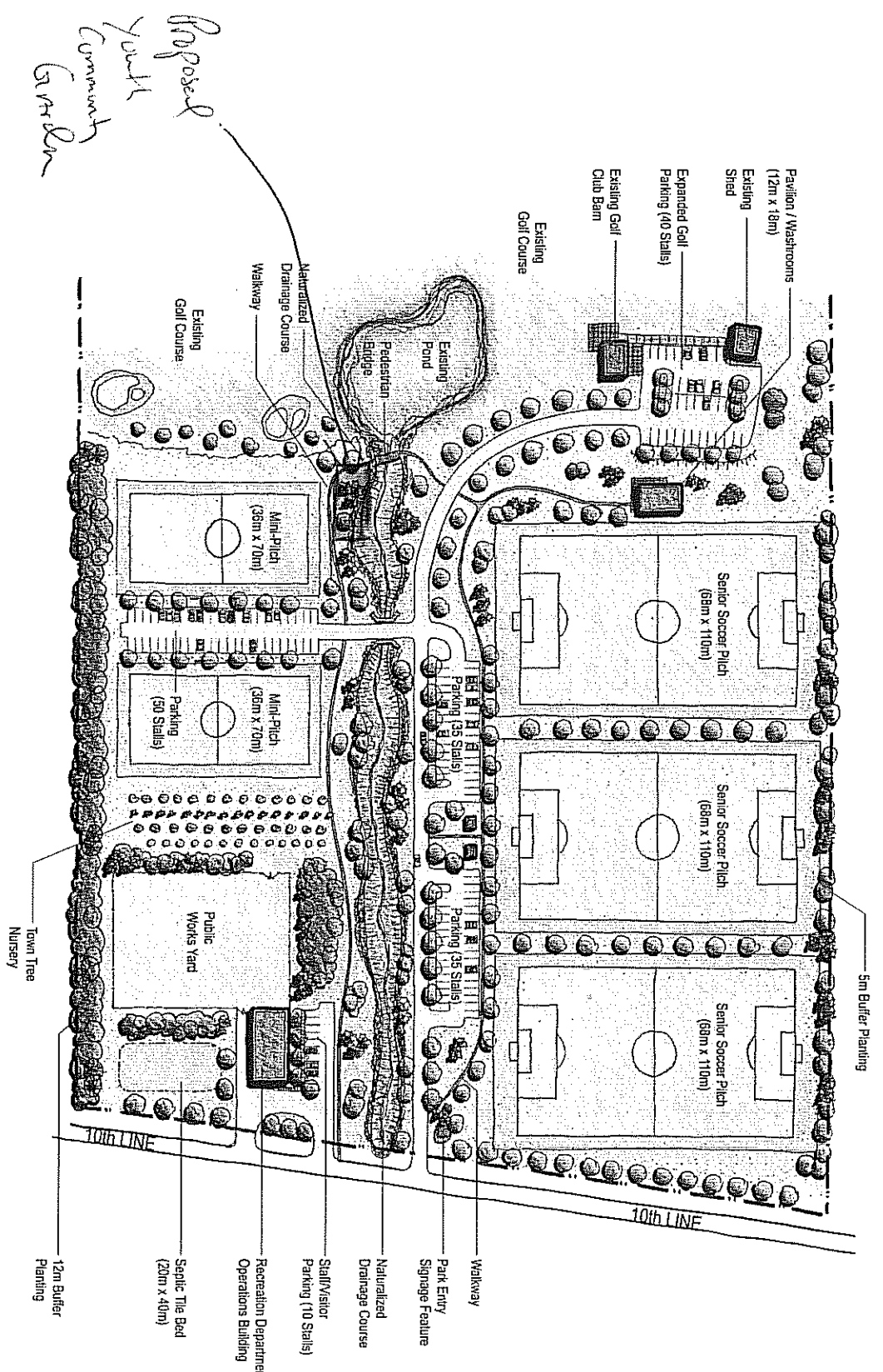

Tomahawk Soccer Park

SCALE 1:750
 JOB NO. ETT00002
 APRIL 21, 2008

PRELIMINARY CONCEPT

0 10 20
 METERS
 SCALE

DESIGN BY TOWN OF THE
 BLUE HORIZONS
 GRAPHICS BY EMMISON RAYMAN