

STAFF REPORT: Recreation

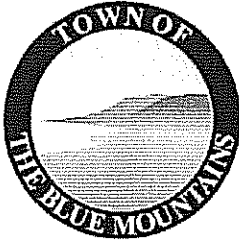

REPORT TO: Council
MEETING DATE: June 9, 2008
REPORT NO.: DOR 08 26
SUBJECT: Off Leash Parks
PREPARED BY: Shawn Everitt, Director of Recreation

A. Recommendations

THAT Council receive Staff Report DOR 08 26 "Off Leash Parks" for information purposes and consider Town Lands on Peel Street in the Thornbury Area and Hamlet Road in the Swiss Meadows area as potential locations for off leash parks with further information to be provided in a subsequent report to Council.

B. Background

Staff has had ongoing discussions with Mr. Norman Patterson, who represents a delegation that was before the Recreation Committee requesting the development of a Dog Park or Off-leash area. In 2007, the Recreation Committee approved the use on a trial basis of one of the existing baseball diamonds as a leash free area. This project would allow staff to determine the use as well as maintenance requirements of such a permanent facility. This project will begin after appropriate gates have been installed to ensure dogs are not exiting the area without the owners while other dogs are entering.

Over the past three to four months, members of the Senior Management Team along with input from the Building and By-law Department have discussed the above specified locations for off leash areas. Further discussions with Norman Patterson have determined that the above noted locations for additional off-leash areas would be beneficial. Staff has identified that proper signage and fencing would be required at locations and would be proposed in the 2009 capital budget process. Other enhancements on properties noted could provide benches, garbage containers as well as potential trailhead parking and linkages in the future.

Staff notes that with any dog park or off-leash area, rules and policies to protect the Town as well as dog owners will be visible by way of signage approved by the Town's Insurance supplier and detailed in the Parks Use By-law.

C. The Blue Mountains' Strategic Plan

Preserving and enhancing natural and environmental features, and cultural heritage of the community.

D. Budget Impact

2009 Capital Budget would reflect fencing and signage costs.

E. Environmental Impacts

To ensure sustainable use of Town Parkland

F. Attached

1. Photo of Peel Street Property with future proposed trails.
2. Map of Peel Street Location
3. Photo of Swiss Meadows Parkland
4. Map of Swiss Meadows Location

Respectfully submitted,

Shawn Everitt, Director of Recreation

Sherri Adams, Manager of Purchasing

1:3,000

Subject Property

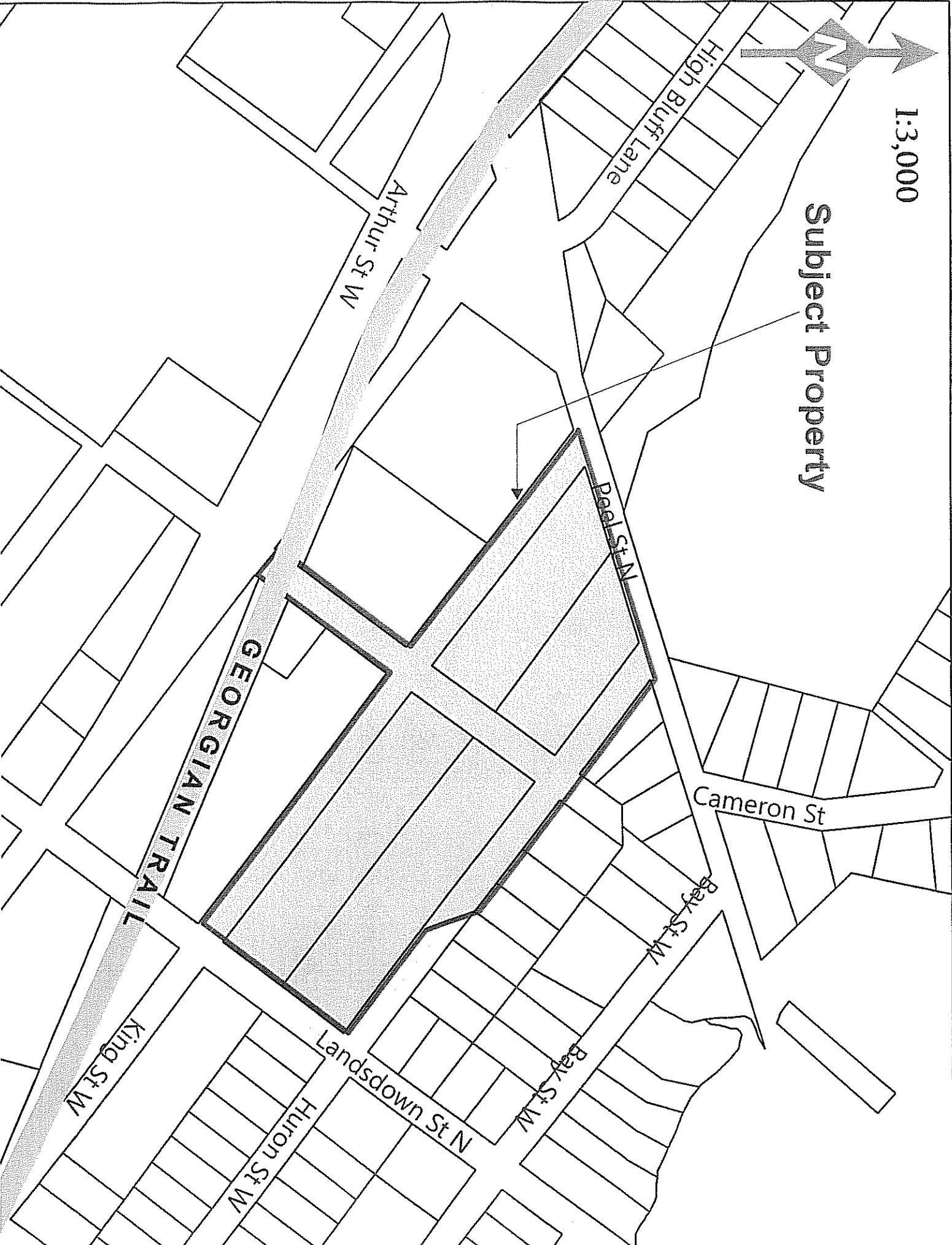

1:10,000



Subject Property



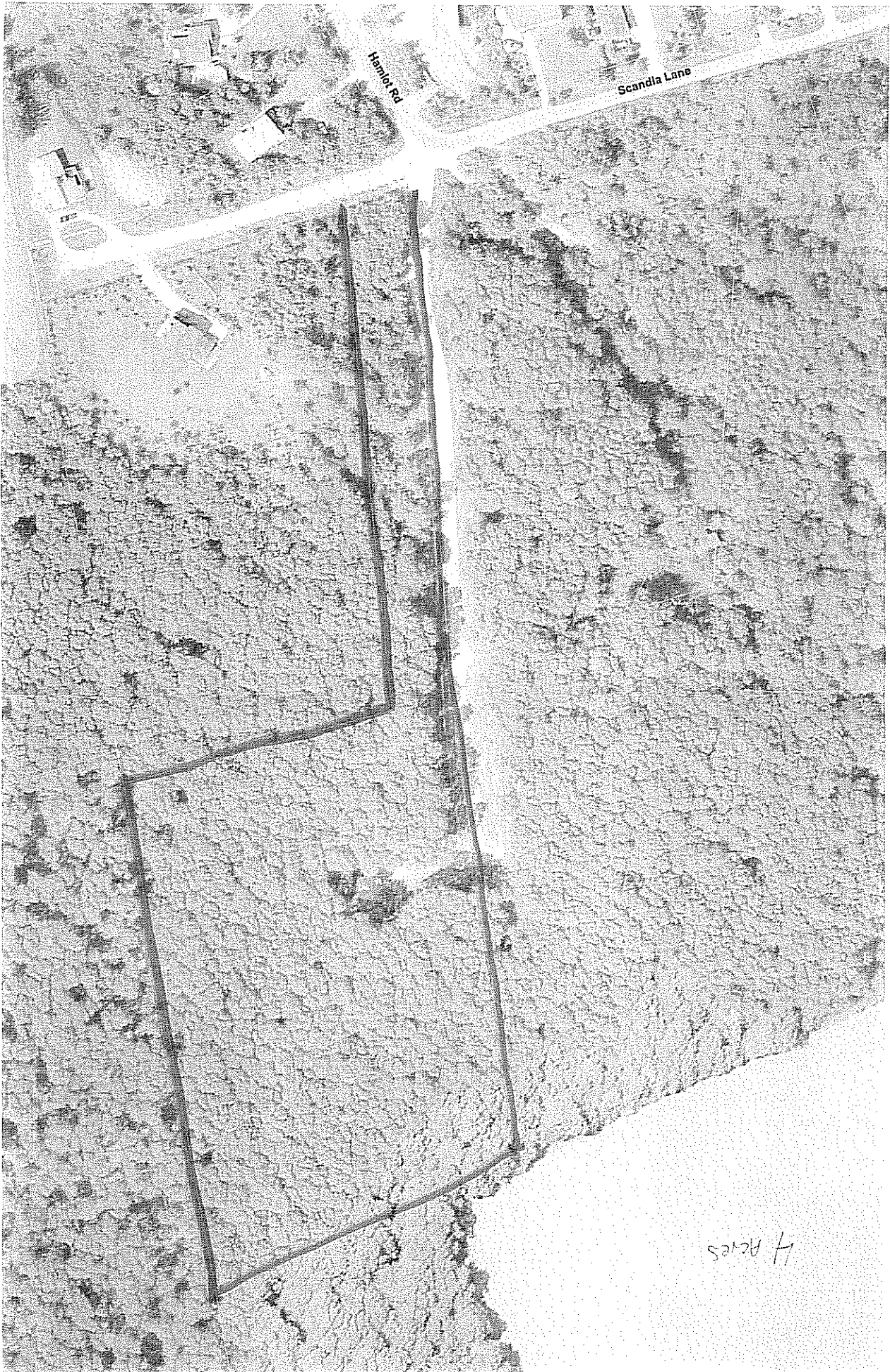

4 Acres



SCALE
1:1,800