

GEORGIAN BAY

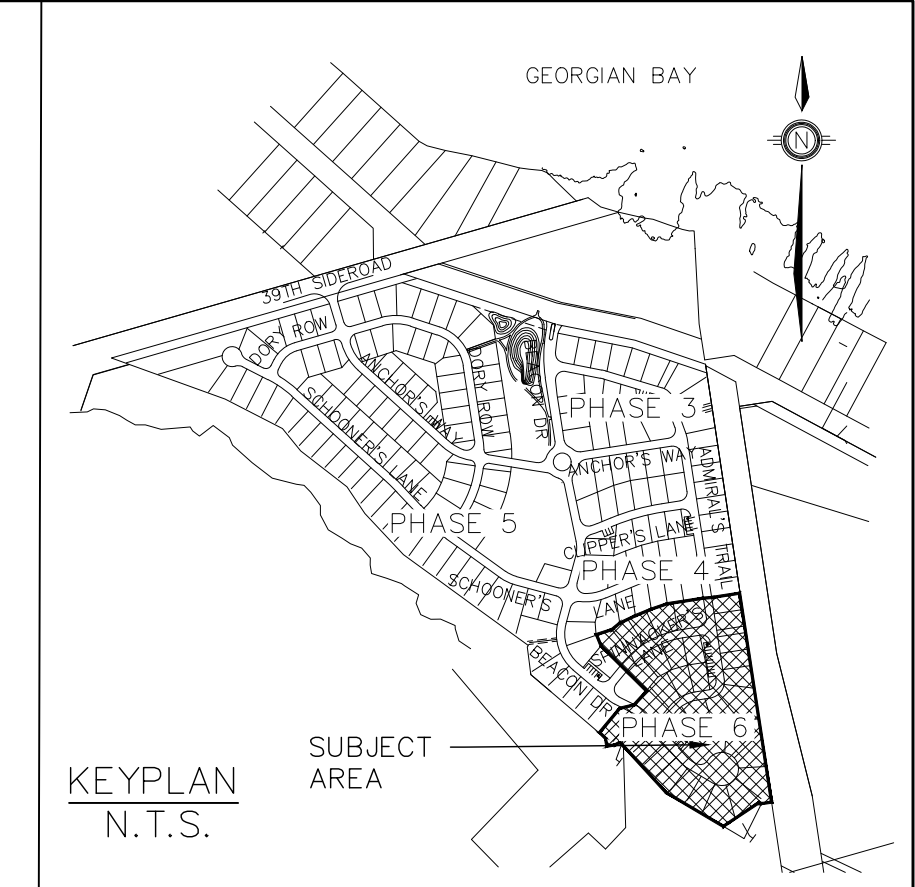
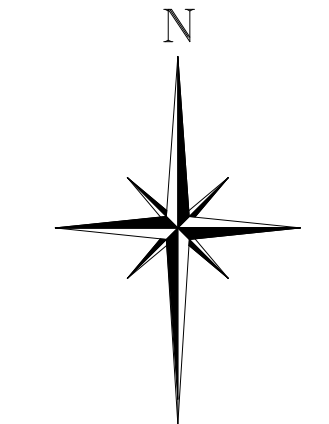

LORA BAY GOLF COURSE & LORA BAY REGIONAL SWM POND (SWM POND No.1)

LORA BAY GOLF COURSE

1. THIS DRAWING IS THE EXCLUSIVE PROPERTY OF C.F. CROZIER & ASSOCIATES INC. AND THE REPRODUCTION OF ANY PART WITHOUT PRIOR WRITTEN CONSENT OF THIS OFFICE IS STRICTLY PROHIBITED.
 2. THE CONTRACTOR SHALL VERIFY ALL DIMENSIONS, LEVELS, AND DATUMS ON SITE AND REPORT ANY DISCREPANCIES OR OMISSIONS TO THIS OFFICE PRIOR TO CONSTRUCTION.
 3. THIS DRAWING IS TO BE READ AND UNDERSTOOD IN CONJUNCTION WITH ALL OTHER PLANS AND DOCUMENTS APPLICABLE TO THIS PROJECT.
 4. DO NOT SCALE THE DRAWINGS.
 5. ALL EXISTING UNDERGROUND UTILITIES TO BE VERIFIED IN THE FIELD BY THE CONTRACTOR PRIOR TO CONSTRUCTION.

GEODETIC BENCHMARK
 GEODETIC BENCHMARK 72U297 HAVING AN ELEVATION OF 231.264m (PUBLISHED 1972), TABLET IN TOP OF ROCK, 25.3m SW OF CENTRE LINE OF HWY NO. 26, 11m SW OF FENCE AND AT ROAD LEVEL.
TEMPORARY BENCHMARKS
 TBM#1: ELEV. 189.05m
 TOP NUT OF FIRE HYDRANT AT SOUTHWEST INTERSECTION OF BEACON DRIVE & ANCHOR'S WAY.
 TBM#2: ELEV. 183.17m
 TOP NUT OF FIRE HYDRANT, NORTH OF UNIT 153, ON SUNSET BOULEVARD, APPROX. 85m EAST OF BEACON DRIVE.

No.	ISSUE	DATE: MMM/DD/YYYY
1	ISSUED FOR 1st SUBMISSION	01/21/2022

Engineer	Engineer

PRELIMINARY
 NOT TO BE USED FOR CONSTRUCTION

Project: COTTAGES AT LORA BAY, PHASE 6 TOWN OF THE BLUE MOUNTAINS
 Drawing: OVERALL PHASING PLAN

CROZIER CONSULTING ENGINEERS
 ADMIRAL BUILDING
 1 FIRST STREET, SUITE 200
 COLLINGWOOD, ON, L9Y 1A1
 705-446-3510 T
 705-446-3520 F
 WWW.CFCROZIER.CA
 INFO@CFCROZIER.CA

Drawn By: B.B.	Design By: B.B./Z.H.	Project: 183-5921
Check By: A.S.	Check By: D.P.	Scale: 1:1250 Drawing: 100